

Mech layout

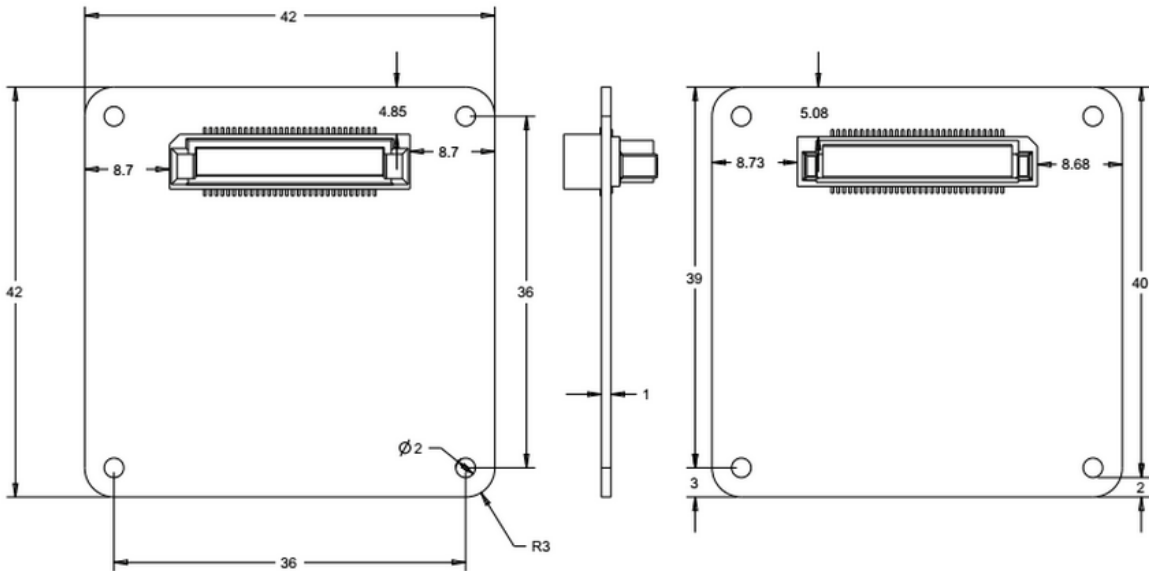

Connector: Hirose F8XC-60

Pinout: See below

version	4			I per pin	0.4
	Pin Number			Derating	0.5
				I	0.2
+3.3_Sw1	P1	P60	3V3 bus	Total Curren	0 pins
+3.3_Sw1	P2	P59	3V3 bus		0 A
RTN_SW1_3V3	P3	P58	3V3 bus	3.3V	4 pins
RTN_SW1_3V3	P4	P57	3V3 bus		0.8 A
+3.3_Sw2	P5	P56	RTN_3V3	battV	4 pins
+3.3_Sw2	P6	P55	RTN_3V3		0.8 A
RTN_SW2_3V3	P7	P54	RTN_3V3	Swx	2 pins
RTN_SW2_3V3	P8	P53	RTN_3V3		0.4 A
+3.3_Sw3	P9	P52	BatV bus	Num switch	6
+3.3_Sw3	P10	P51	BatV bus		2.4 A
RTN_SW3_3V3	P11	P50	BatV bus	Total curren	0
RTN_SW3_3V3	P12	P49	BatV bus		
BatV_SW1	P13	P48	RTN_BatV		
BatV_SW1	P14	P47	RTN_BatV		
RTN_SW1_BatV	P15	P46	RTN_BatV		
RTN_SW1_BatV	P16	P45	RTN_BatV		
BatV_SW2	P17	P44	GPIO7_PO		
BatV_SW2	P18	P43	GPIO6_PO		
RTN_SW2_BatV	P19	P42	GPIO5_PO		
RTN_SW2_BatV	P20	P41	GPIO4_PO		
BatV_SW3	P21	P40	GPIO3_PO		
BatV_SW3	P22	P39	GPIO2_PO		
RTN_SW3_BatV	P23	P38	GPIO1_PO		
RTN_SW3_BatV	P24	P37	GPIO0_PO		
GPIO0_PT	P25	P36	/SS		
GPIO1_PT	P26	P35	SCK		
/RST	P27	P34	MISO		
GND	P28	P33	MOSI		
SCL	P29	P32	GPIO3_PT		
SDA	P30	P31	GPIO2_PT		